

Specification Sheet

Item No.: _____
 Project No.: _____
 S.I.S. No.: _____

Hangers and Hanger Bar Kits

MODELS:

- | | | |
|--|--|--|
| <input type="checkbox"/> <i>CLH-C</i> | <input type="checkbox"/> <i>TPH-C</i> | <input type="checkbox"/> <i>HBK-60C</i> |
| <input type="checkbox"/> <i>CLH-S</i> | <input type="checkbox"/> <i>TPH-S</i> | <input type="checkbox"/> <i>HBK-60S</i> |
| <input type="checkbox"/> <i>CLH-EP</i> | <input type="checkbox"/> <i>TPH-EP</i> | <input type="checkbox"/> <i>HBK-60EP</i> |
| <input type="checkbox"/> <i>OLH-C</i> | <input type="checkbox"/> <i>HBK-48C</i> | <input type="checkbox"/> <i>HBK-72C</i> |
| <input type="checkbox"/> <i>OLH-S</i> | <input type="checkbox"/> <i>HBK-48S</i> | <input type="checkbox"/> <i>HBK-72S</i> |
| <input type="checkbox"/> <i>OLH-EP</i> | <input type="checkbox"/> <i>HBK-48EP</i> | <input type="checkbox"/> <i>HBK-72EP</i> |

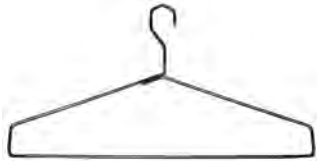

open loop hanger

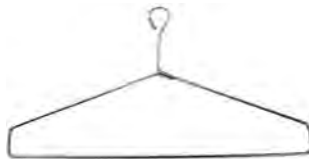

closed loop hanger

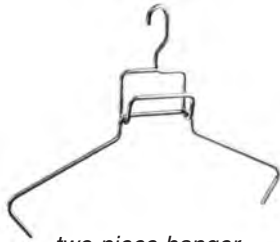

two-piece hanger



hanger bar kit

Open and Closed Loop Hangers

- For freestanding or wall mounted gowning racks, removable and non-removable hanger models.
- Accommodates 1" (25mm)-diameter hanger rods.
- Closed loop hangers discourage removal from the gowning area.

Two-Piece Hangers

- For use with non-removable hanger models.
- Top component is affixed to the gowning rack, while the bottom component is removable for convenient mounting of the garment.
- These hangers discourage removal from the gowning area.

Hanger Bar Kits *

- Converts existing wire shelving into freestanding or wall mounted gowning racks.
- End brackets clip onto underside of wire shelf, hanger bar bolts onto end brackets.
- Hanger slots on standard 2½" (64mm) centers. Other spacing available.
- For use with two-piece hangers and open loop hangers only.
- Mounts onto underside of 24" (610mm)-wide wire shelves only.

* Hangers not included with Hanger Bar Kits.



Cleanroom World

6950 South Tuscon Way, Ste F
 Centennial, CO 80112
 Ph: (303)752-0076 Fx: (303)752-0288
www.CleanroomWorld.com



Item No.: _____
 Project No.: _____
 S.I.S. No.: _____

Hangers

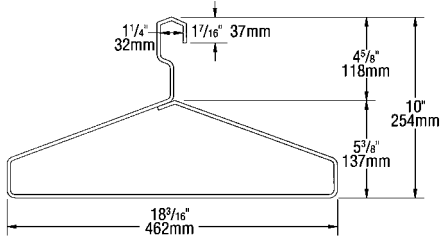

Open Loop Hangers

chrome model #	stainless model #	electropolished model #	weight	
<i>OLH-C</i>	<i>OLH-S</i>	<i>OLH-EP</i>	0.4	0.2

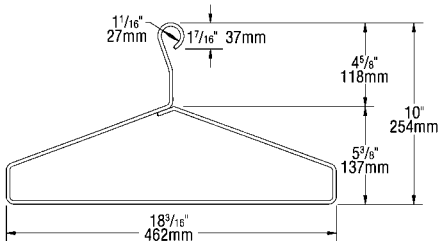

Closed Loop Hangers

chrome model #	stainless model #	electropolished model #	weight	
<i>CLH-C</i>	<i>CLH-S</i>	<i>CLH-EP</i>	0.4	0.2

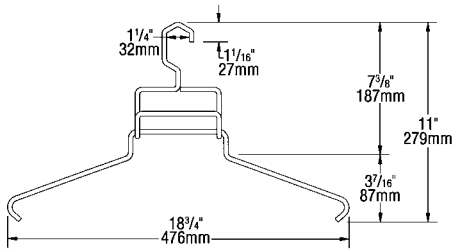

Two-Piece Hangers

chrome model #	stainless model #	electropolished model #	weight	
<i>TPH-C</i>	<i>TPH-S</i>	<i>TPH-EP</i>	0.5	0.2

Hanger Bar Kits



chrome model #	stainless model #	electropolished model #	length	weight	# of hanger slots		
			in.	mm	lbs.	kg	
<i>HBK-48C</i>	<i>HBK-48S</i>	<i>HBK-48EP</i>	48"	1219	7.0	3.2	17
<i>HBK-60C</i>	<i>HBK-60S</i>	<i>HBK-60EP</i>	60"	1524	9.5	4.3	22
<i>HBK-72C</i>	<i>HBK-72S</i>	<i>HBK-72EP</i>	72"	1829	12.0	5.4	27

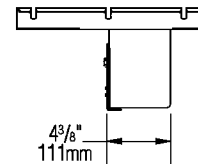
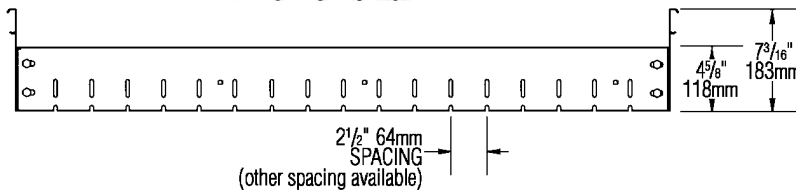

Cleanroom World

6950 South Tuscon Way, Ste F
 Centennial, CO 80112
 Ph: (303)752-0076 Fx: (303)752-0288
www.CleanroomWorld.com